

TLES5F

Energy-optimized Compressor

R134a

220-240V 50Hz

Data Sheet (Replaces CG.42.E2.02)

General

Compressor	TLES5F
Code number	102G4510

Application

Application		LBP
Evaporating temperature range	°C	-35 to -10
Voltage range	V/Hz	198 - 254 /50
Motor type		RSIR/RSCR
Max. ambient temperature	°C	43*
Comp. cooling at ambient temp.	32°C	S
	38°C	S
	43°C	S

* run capacitor 4 µF recommended in 43°C ambient temperature

Design

Displacement	cm ³	5.08
Oil quantity	cm ³	180
Maximum refrigerant charge	g	400
Free gas vol. in compressor	cm ³	1790
Weight without electrical equipment	kg	7.6

Motor

Motor size	watt	105
LRA (rated after 4 sec. UL984) LST	A	4.0
Cut-in current LST	A	8.5
Resistance, main and start winding (25°C)	Ω	18.9/15.3
Approvals		EN 60335-2-34 with Annex AA

Dimensions

Height	mm	A	173
		B	169
Suction connector	location/I.D. mm	C	6.2 ±0.09
Process connector	location/I.D. mm	D	6.2 ±0.09
Discharge connector	location/I.D. mm	E	5.0 +0.12/+0.20
Compressors on a pallet	pcs.		125

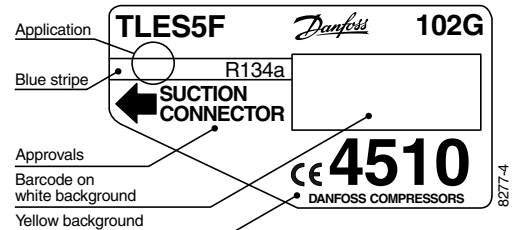

- S = Static cooling normally sufficient
- O = Oil cooling
- F₁ = Fan cooling 1.5 m/s
(compressor compartment temperature equal to ambient temperature)
- F₂ = Fan cooling 3.0 m/s necessary

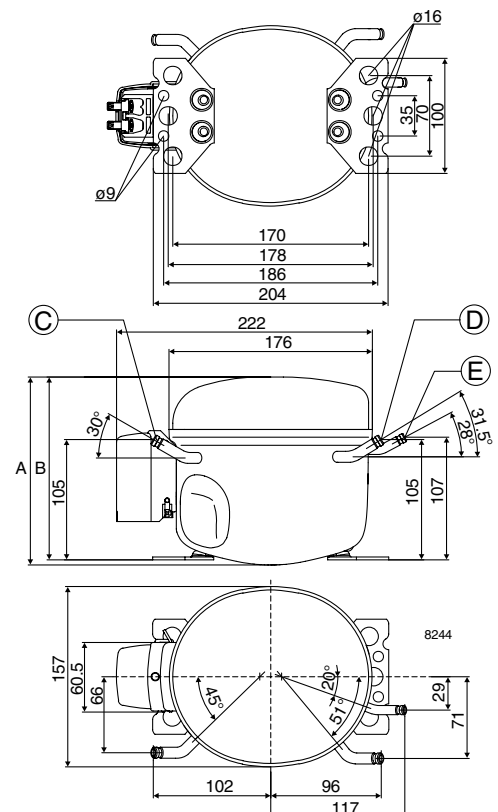

Capacity (EN 12900/CECOMAF)

watt

Comp.\°C	-35	-30	-25	-23.3	-20	-15	-10
TLES5F	49.9	71.5	98.0	108	130	169	216

Capacity (ASHRAE)

watt

Comp.\°C	-35	-30	-25	-23.3	-20	-15	-10
TLES5F	61.5	88.1	121	134	161	209	267

Power consumption

watt

Comp.\°C	-35	-30	-25	-23.3	-20	-15	-10
TLES5F	77.3	90.5	105	110	121	139	158

Current consumption

A

Comp.\°C	-35	-30	-25	-23.3	-20	-15	-10
TLES5F	0.59	0.65	0.71	0.73	0.78	0.85	0.92

COP (EN 12900/CECOMAF)

W/W

Comp.\°C	-35	-30	-25	-23.3	-20	-15	-10
TLES5F	0.65	0.79	0.93	0.98	1.08	1.22	1.37

COP (ASHRAE)

W/W

Comp.\°C	-35	-30	-25	-23.3	-20	-15	-10
TLES5F	0.80	0.97	1.15	1.21	1.33	1.51	1.69

Test conditions	EN 12900/CECOMAF	ASHRAE
Condensing temperature	55°C	55°C
Ambient and suction gas temp.	32°C	32°C
Liquid temperature	55°C	32°C
Static cooling, 220V 50Hz,		
PTC consumption incl.		

Accessories

Devices	Fig.	TLES5F
PTC starting device	6.3 mm spades	a1 103N0011
	4.8 mm spades	(pos.1) 103N0018
PTC starting device	6.3 mm spades	a1 103N0016
	4.8 mm spades	(pos.2) 103N0021
Cover	b	103N2010
Cord relief	d	103N1010
Run capacitor 4 µF (optional)	6.3 mm spades	e 117-7117
	4.8 mm spades	e 117-7119
Protection screen for PTC	g	103N0476
Mounting accessories		
Bolt joint for one compressor		118-1917
Bolt joint in quantities		118-1918
Snap-on in quantities		118-1919

* run capacitor 4 µF recommended in 43°C ambient temperature

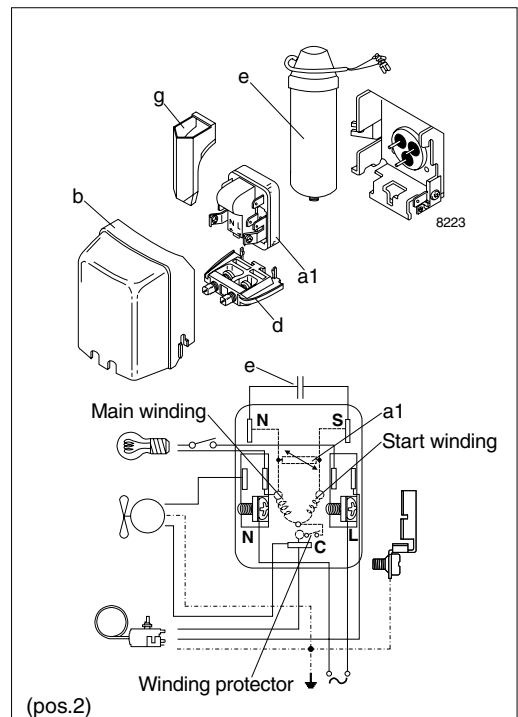
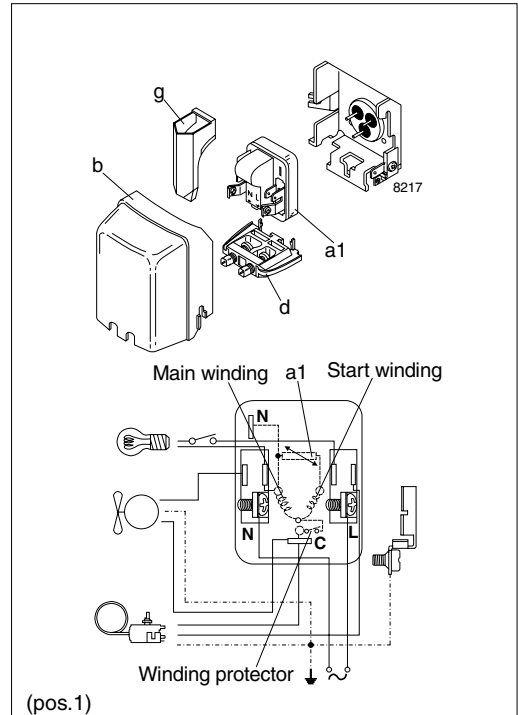

Danfoss can accept no responsibility for possible errors in catalogues, brochures and other printed material. Danfoss reserves the right to alter its products without notice. This also applies to products already on order provided that such alterations can be made without subsequential changes being necessary in specifications already agreed. All trademarks in this material are property of the respective companies. Danfoss and the Danfoss logotype are trademarks of Danfoss A/S. All rights reserved.

