

# SC15CNX

## LBP/MBP Compressor

### R290 (Propane)

### 220-240V 50Hz

Data Sheet (Replaces CH.54.C3.02)

#### General

Compressor	<b>SC15CNX</b>
Code number	104H8565

#### Application

Application	LBP/MBP	
Evaporating temperature range	°C	-40 to 5
Voltage range	V/Hz	198 - 254 /50
Motor type	CSR	
Max. ambient temperature	°C	43
Comp. cooling at ambient temp.	32°C	F <sub>2</sub>
	38°C	F <sub>2</sub>
	43°C	F <sub>2</sub>

#### Design

Displacement	cm <sup>3</sup>	15.28
Oil quantity	cm <sup>3</sup>	600
Maximum refrigerant charge	g	150
Free gas vol. in compressor	cm <sup>3</sup>	1410
Weight without electrical equipment	kg	13.1

#### Motor

Motor size	watt	385
LRA (rated after 4 sec. UL984) HST	A	14.8
Cut-in current HST	A	14.8
Resistance, main and start winding (25°C)	Ω	5.0/13.7
Approvals	EN 60335-2-34	

#### Dimensions

Height	mm	A	209
		B	203
		B1	183
		B2	110
Suction connector	location/I.D. mm	C	8.2 ±0.09
Process connector	location/I.D. mm	D	6.2 ±0.09
Discharge connector	location/I.D. mm	E	6.2 ±0.09
Compressors on a pallet	pcs.	80	

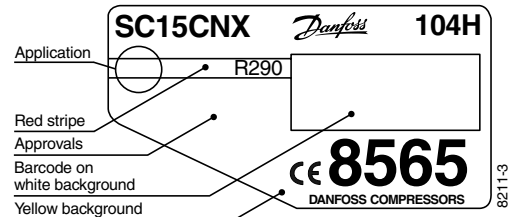

- S = Static cooling normally sufficient
- O = Oil cooling
- F<sub>1</sub> = Fan cooling 1.5 m/s  
(compressor compartment temperature equal to ambient temperature)
- F<sub>2</sub> = Fan cooling 3.0 m/s necessary

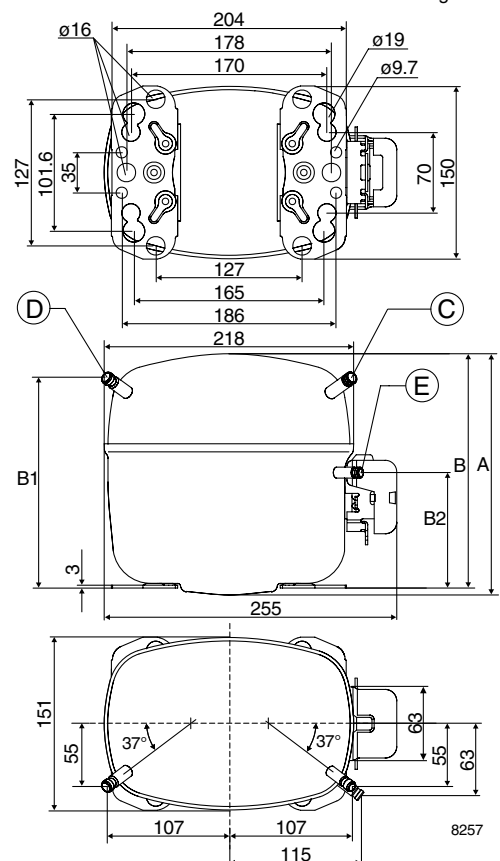

### Capacity (EN 12900/CECOMAF)

watt

Comp. °C	-40	-35	-30	-25	-23.3	-20	-15	-10	-5	0	5
SC15CNX	195	297	415	550	601	707	887	1093	1328	1594	1894

### Capacity (ASHRAE)

watt

Comp. °C	-40	-35	-30	-25	-23.3	-20	-15	-10	-5	0	5
SC15CNX	217	331	462	614	671	789	991	1221	1485	1784	2122

### Power consumption

watt

Comp. °C	-40	-35	-30	-25	-23.3	-20	-15	-10	-5	0	5
SC15CNX	256	315	370	420	436	467	514	560	608	659	715

### Current consumption

A

Comp. °C	-40	-35	-30	-25	-23.3	-20	-15	-10	-5	0	5
SC15CNX	1.28	1.55	1.82	2.08	2.17	2.33	2.58	2.82	3.05	3.27	3.49

### COP (EN 12900/CECOMAF)

W/W

Comp. °C	-40	-35	-30	-25	-23.3	-20	-15	-10	-5	0	5
SC15CNX	0.76	0.94	1.12	1.31	1.38	1.51	1.73	1.95	2.18	2.42	2.65

### COP (ASHRAE)

W/W

Comp. °C	-40	-35	-30	-25	-23.3	-20	-15	-10	-5	0	5
SC15CNX	0.85	1.05	1.25	1.46	1.54	1.69	1.93	2.18	2.44	2.71	2.97

Test conditions  
 Condensing temperature  
 Ambient and suction gas temp.  
 Liquid temperature  
 Fan cooling F<sub>2</sub>, 220V 50Hz

EN 12900/CECOMAF  
 45°C  
 32°C  
 45°C

ASHRAE  
 45°C  
 32°C  
 32°C

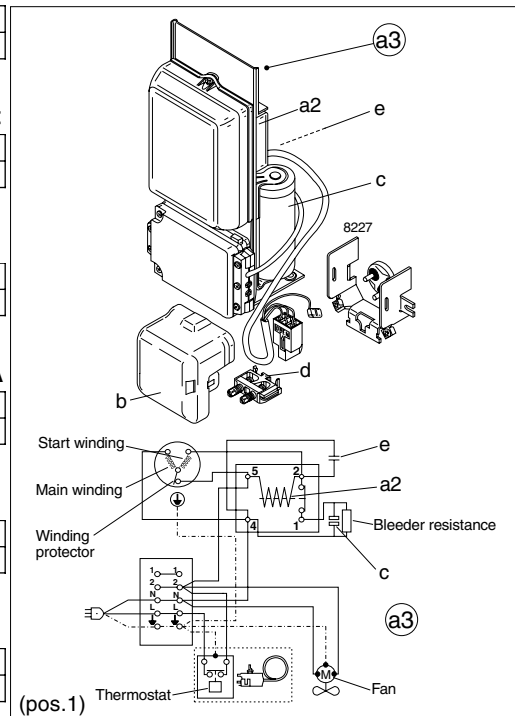

### Accessories

Devices	Fig.	SC15CNX
Starting device	a3 (pos.1)	117-7051 (470 mm cable length)
Starting device (kit)	(pos.2)	117-9711 (1020 mm cable length)
Cover	b	103N2009
Starting relay	a2	Components of starting device
Starting capacitor	c	
Run capacitor	e	
Cord relief	d	
Mounting accessories		
Bolt joint for one compressor		118-1917
Bolt joint in quantities		118-1918
Snap-on in quantities		118-1919

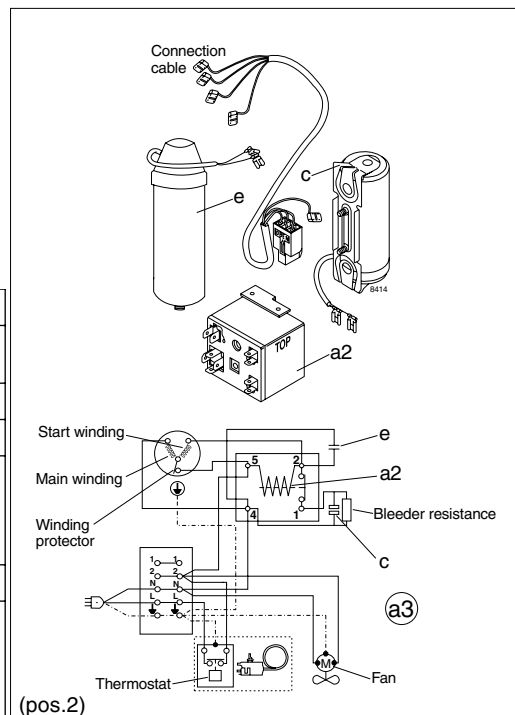

Danfoss can accept no responsibility for possible errors in catalogues, brochures and other printed material. Danfoss reserves the right to alter its products without notice. This also applies to products already on order provided that such alterations can be made without subsequential changes being necessary in specifications already agreed. All trademarks in this material are property of the respective companies. Danfoss and the Danfoss logotype are trademarks of Danfoss A/S. All rights reserved.

