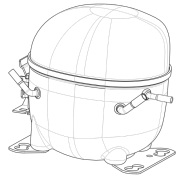

**115V 60 1~****GENERAL DATA**

**Application:** LBP  
**Refrigerant:** R134a  
**Evaporating Temperature Range:** -30°C to -5°C  
**Compressor Cooling:** Fan  
**Fan air flow:** 520 m<sup>3</sup>/h  
**Type:** Hermetic reciprocating  
**Technology Type:** On-Off  
**Expansion Device:** Capillary Tube or Expansion Valve  
**Packing Quantity:** Single - 1 pc  
**Displacement:** 16.8 cm<sup>3</sup>  
**Horse power:** 1.2 hp

Approvals:   

**MECHANICAL DATA**

**Bore:** 31.19 mm  
**Stroke:** 22 mm  
**Oil Charge:** 350ml +/-15ml  
**Free Internal Volume:** 2.1 cm<sup>3</sup>  
**Maximum Recommended Refrigerant Charge:** 350 g  
**Oil Type Configuration:** Polyolester  
**Oil Type Viscosity:** ISO22  
**Compressor pressurization:** Dry air charge  
**Weight:** 11.3 kg

**ELECTRICAL DATA**

**Motor Type:** CSIR  
**Starting Torque:** HST  
**Voltage working range at 60 Hz:** 103-127 V  
**Maximum Motor Temperature:** 130 °C  
**Start Winding Resistance:** 6.54 Ω (± 10%) at 25°C  
**Run Winding Resistance:** 0.89 Ω (± 10%) at 25°C  
**Locked Rotor Amperage (LRA):** 40 A

**MOUNTING ACCESSORIES**

	Description	Code
<b>Terminal Board:</b>	no	-
<b>Anchorage:</b>	no	-
<b>Washer:</b>	no	-
<b>Pin:</b>	no	-
<b>Clip:</b>	no	-
<b>Rotolock valve:</b>	no	-
<b>Overload Protector Bracket:</b>	yes	2075299
<b>Cover:</b>	yes	2075278
<b>Grommets:</b>	yes	2221003
<b>Sleeves:</b>	yes	2222015
<b>Capacitor Bracket:</b>	yes	2255006

**ELECTRICAL COMPONENTS**

	Component type	Description	Code
<b>Start Capacitor:</b>		189-227 MFD 250V	2252324
<b>Starting Device:</b>	Current relay	MTRPH-68-31	2271154
<b>Motor Protection:</b>	External 3/4"	T0793/J5	2324092

**EXTERNAL CHARACTERISTICS**

**Base Plate:** Universal  
**Tray Holder:** No  
**Height:** 206 mm

	Internal Diameter (mm)	Material	Shape
<b>Suction Connector</b>	8.1	Copper	Slanted 42°
<b>Discharge Connector</b>	6.45	Copper	Straight
<b>Process Connector</b>	6.45	Copper	Slanted 42°

**RATED POINT DATA**

Cooling Capacity (W)	Power Consumption (W)	Current Consumption (A)	Gas Flow Rate (kg/h)	Efficiency (W/W)
±5%	±5%	±5%	±5%	±7%
390	415	5.96	10.24	0.94

Test condition: ARI 540, Fan, Return Gas 4.4°C, Subcooling OK, Evaporating: -23.3°C, Condensing: 49°C, Ambient: 35°C

**PERFORMANCE CURVE DATA**

**115V 60Hz**

Condensing Temperature (°C)	Evaporating Temperature (°C)	Cooling Capacity (W)	Power Consumption (W)	Current Consumption (A)	Gas Flow Rate (kg/h)	Efficiency (W/W)
		±5%	±5%	±5%	±5%	±7%
<b>35°C</b>	-5	1 155	623	7.32	26.84	1.85
	-10	936	557	6.86	21.61	1.68
	-15	744	494	6.46	17.08	1.51
	-20	579	435	6.09	13.22	1.33
	-25	440	379	5.76	10.02	1.16
	-30	328	326	5.46	7.43	1.00

Condensing Temperature (°C)	Evaporating Temperature (°C)	Cooling Capacity (W)	Power Consumption (W)	Current Consumption (A)	Gas Flow Rate (kg/h)	Efficiency (W/W)
		±5%	±5%	±5%	±5%	±7%
<b>45°C</b>	-5	1 030	674	7.68	26.51	1.53
	-10	829	594	7.10	21.16	1.40
	-15	653	520	6.60	16.56	1.26
	-20	503	452	6.17	12.68	1.11
	-25	378	390	5.82	9.51	0.97
	-30	279	334	5.52	7.01	0.84

Condensing Temperature (°C)	Evaporating Temperature (°C)	Cooling Capacity (W)	Power Consumption (W)	Current Consumption (A)	Gas Flow Rate (kg/h)	Efficiency (W/W)
		±5%	±5%	±5%	±5%	±7%
<b>55°C</b>	-5	876	725	8.02	25.36	1.21
	-10	699	631	7.32	20.05	1.11
	-15	546	545	6.73	15.55	1.00
	-20	418	469	6.26	11.83	0.89
	-25	314	401	5.88	8.86	0.78

Test condition: ARI 540, Fan, Return Gas 4.4°C, Subcooling OK, Ambient: 35°C

**ASSEMBLY INSTRUCTION**

**WIRING DIAGRAM**

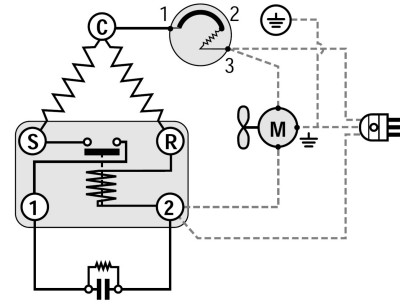
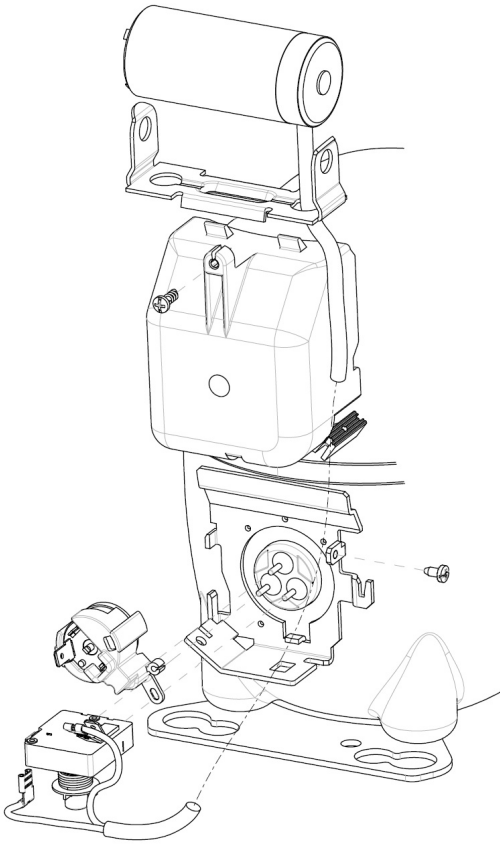

**OPERATING ENVELOPE**

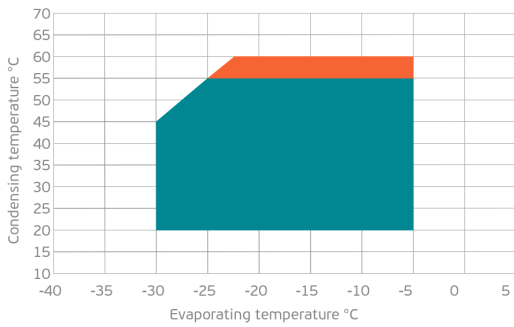

- Operating Condition
- Transient Condition
- Superheating

**NOTE:** usage of compressors outside of intended working range cannot make use of the warranty, or should be consulted with Technical support.

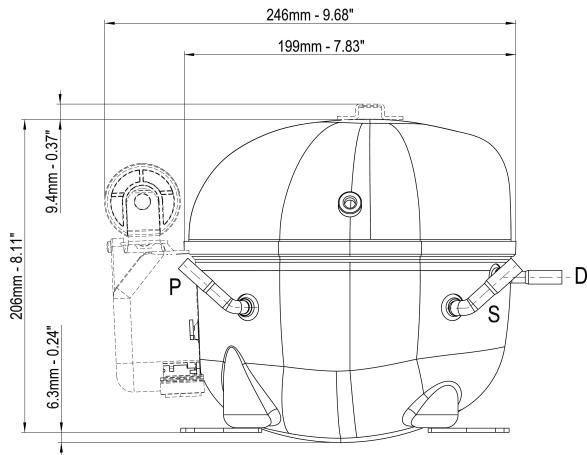

	∅ mm	∅ in	Material
<b>S - Suction</b>	8.10 - 8.20	0.32	Cu
<b>P - Process</b>	6.45 - 6.55	0.25	Cu
<b>D - Discharge</b>	6.45 - 6.55	0.25	Cu

